

Fixed Workbench Castor Instructions:

This castor set allows for your workbench to be lifted off the ground (to an approximate height of 25.4mm/1" – see installation card for reference) and repositioned easily.

To operate, press down on the foot pedal of each castor to elevate your workbench, and move to your desired location. To disable movement, lift the foot pedal to lower the workbench firmly back onto the floor. Each 75mm (3") polyurethane castor can support up to 100kg (400kgs combined set capacity). Each swivel castor can pivot 360° once raised. All required mounting hardware is included.

- Suitable for workbenches up to 400kgs
- 4 free-swivelling 75mm (3") diameter polyurethane castors
- Simple to operate
- Mounting screws included for easy installation

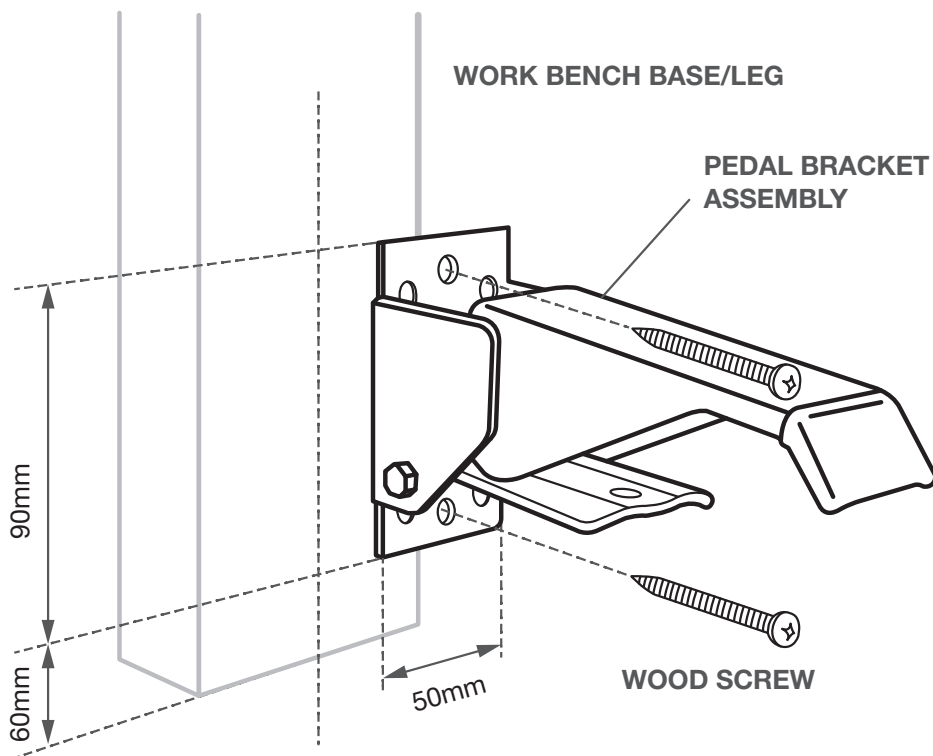

STEP 01

To install the plate, mark the holes for drilling with the included "easy-install" template and attach using the wood screws provided. Use the 4 corner holes for the best stability. If your bench leg is less than 75mm wide, use the two centre holes in the mounting plate.

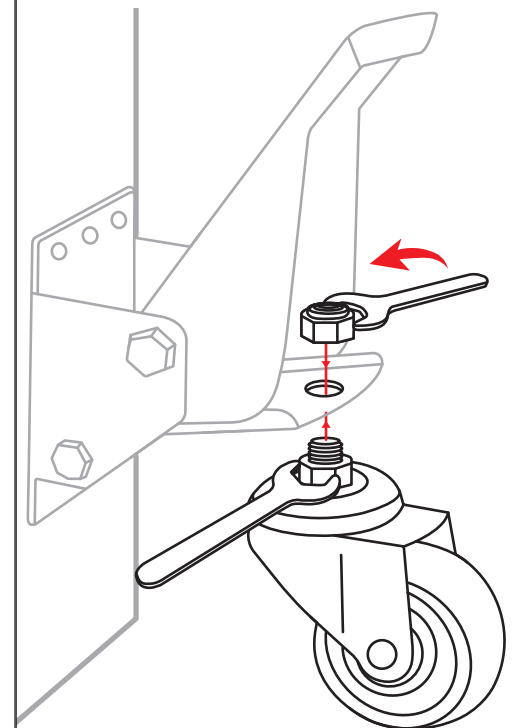

STEP 02

Attach the castors by placing the castor bolt through the hole in the plate, and threading on the M12 nut by hand. Tighten using the wrenches provided.