

# Remote External Receiver Users Manual GTR197

The GTR197 is an optional accessory that allows you to use the Richmond swing or sliding gate remotes on another manufacturers garage or gate motor. This allows you to operate multiple motors with a single remote and can also be fitted to replace remotes that are no longer available.

- It also allows up to 250 remotes to be paired to your motor via the receiver
- This accessory is suitable for all Richmond gate motors as well as a long list of other manufacturers gate and garage motors.
- See following pages for a fitment guide, along with a wiring example.

If you need assistance finding your connection points, or are unsure if your motor is suitable, please contact the team at Richmond Wheel & Castor.

03 9070 5713 [gatesupport.richmondau.com](http://gatesupport.richmondau.com)



## GTR179

Remote to suit GTR064, GTR061, GTR156, GTR207, and GTR212 sliding gate motors

\*Button 4 not available if the remote is also paired to a Richmond sliding gate motor. Pedestrian mode is operated from button 4



## GTR054

Remote to suit GTR099, GTR058, GTR062, and GTR078 swing gate motors

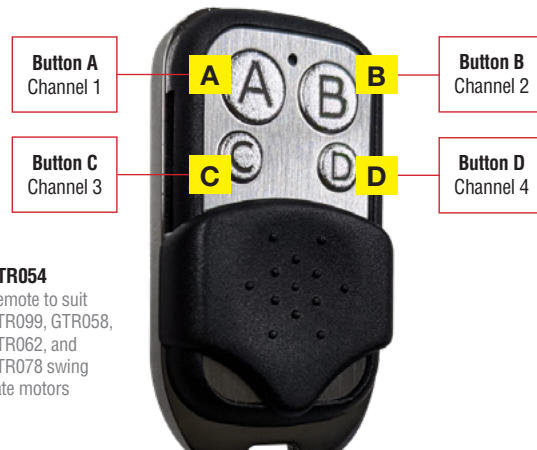

# How to connect to the GTR156 and GTR212 sliding gate motor control board:

The below diagram shows how to connect the wires from the **GTR197** external remote receiver to the **GTR156 & GTR212 Gate Openers**. See following pages for pairing instructions.

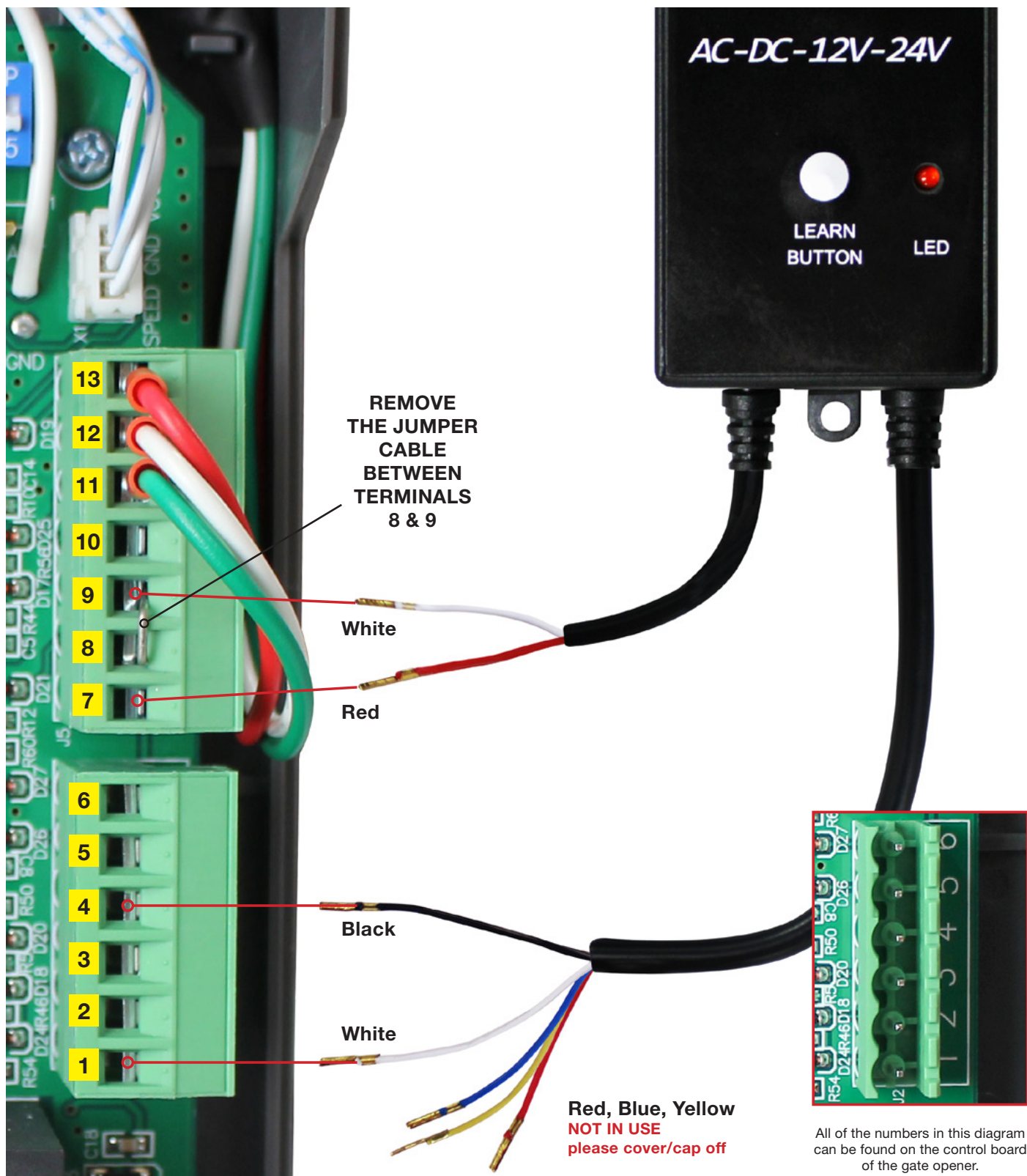



# How to connect to the GTR064, GTR061 & GTR207 sliding gate motor control boards:

The below diagram shows how to connect the wires from the **GTR197** external remote receiver to the **GTR064, GTR061 and GTR207 Automatic Gate Openers**. See following pages for pairing instructions.

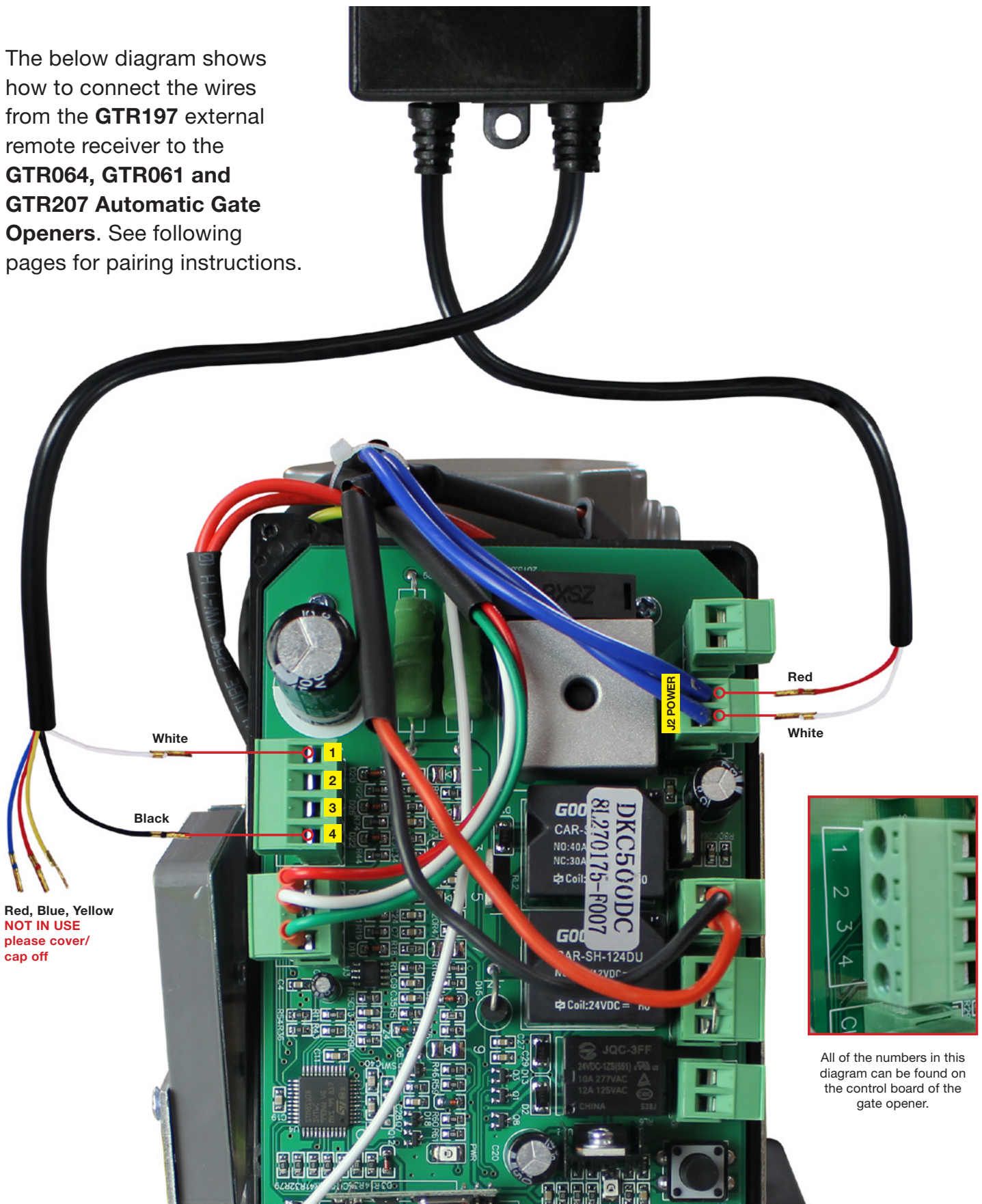

\*GTR064 model is shown. Other models may have the PC board upside down

# How to connect to the GTR099 swing gate motor control board:

The below diagram shows how to connect the wires from the **GTR197** external remote receiver to the **GTR099 Gate Opener**. See following pages for pairing instructions.

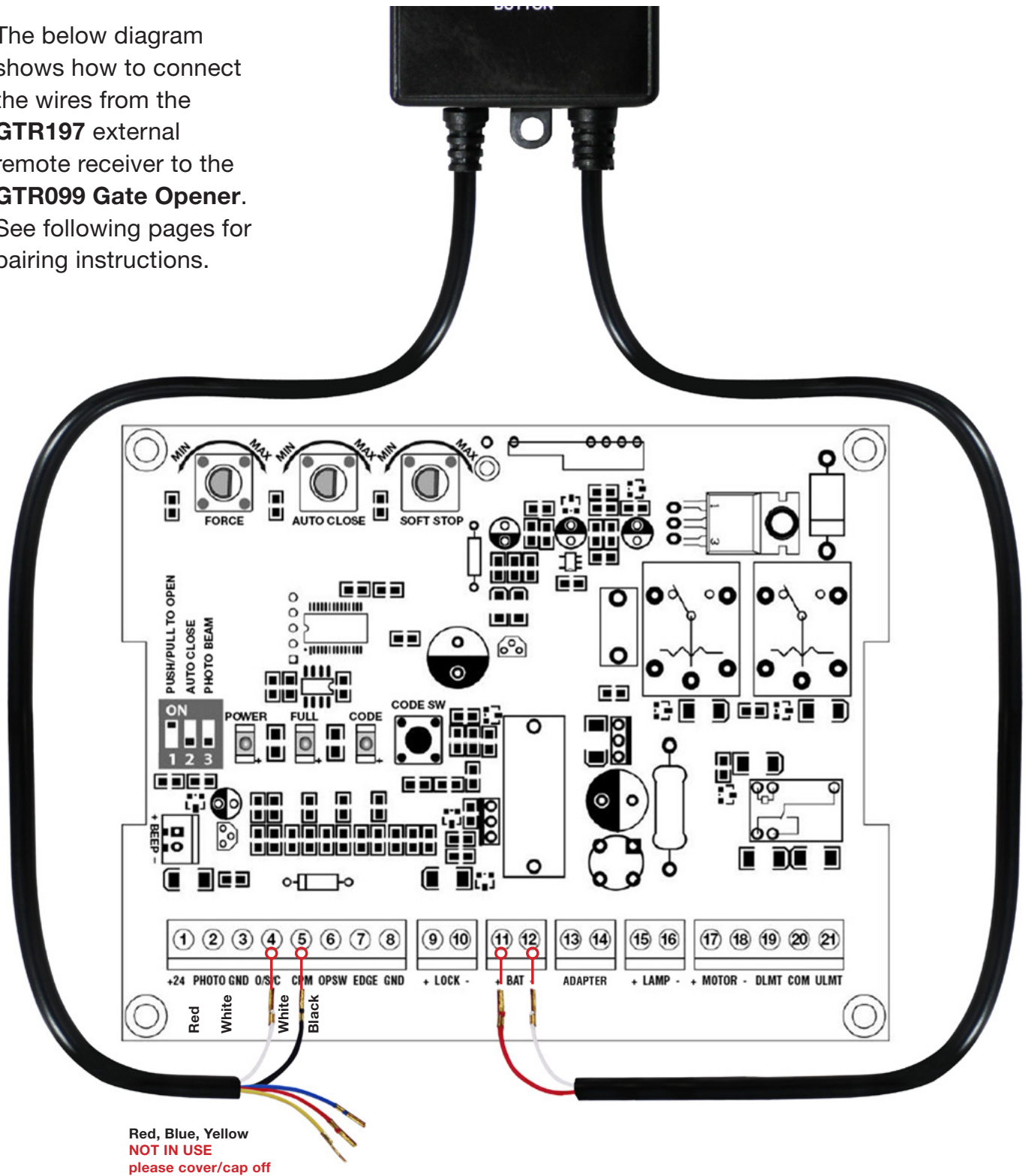

# How to connect to the GTR058 swing Gate motor control board:

The below diagram shows how to connect the wires from the **GTR197** external remote receiver to the **GTR058 Double Swing Gate Opener**. See following pages for pairing instructions.

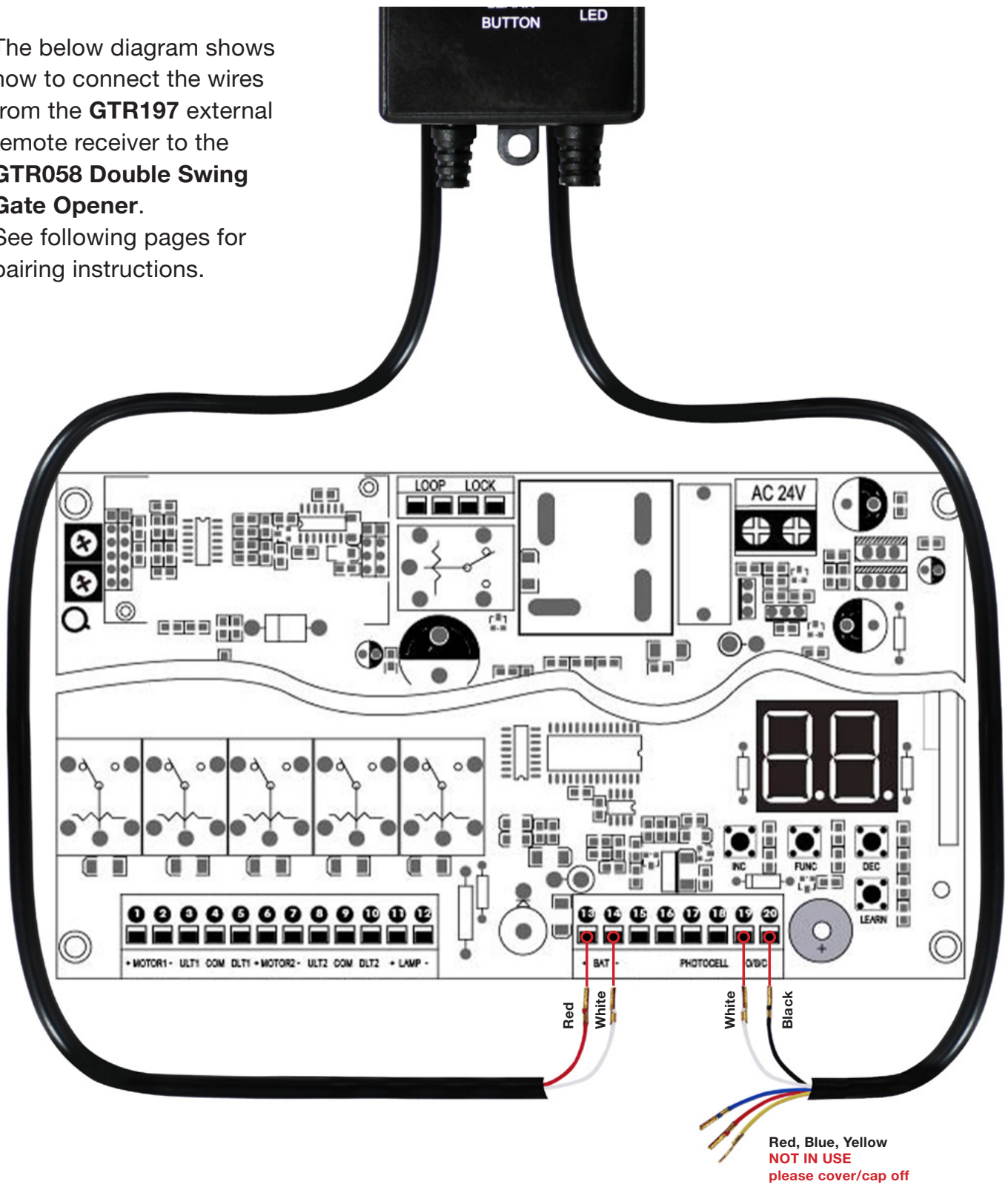



# How to connect to the GTR062 and GTR078 solar swing gate motor control boards:

The below diagram shows how to connect the wires from the **GTR197** external remote receiver to the **GTR062** and **GTR078** Solar Swing Gate Openers. See following pages for pairing instructions.

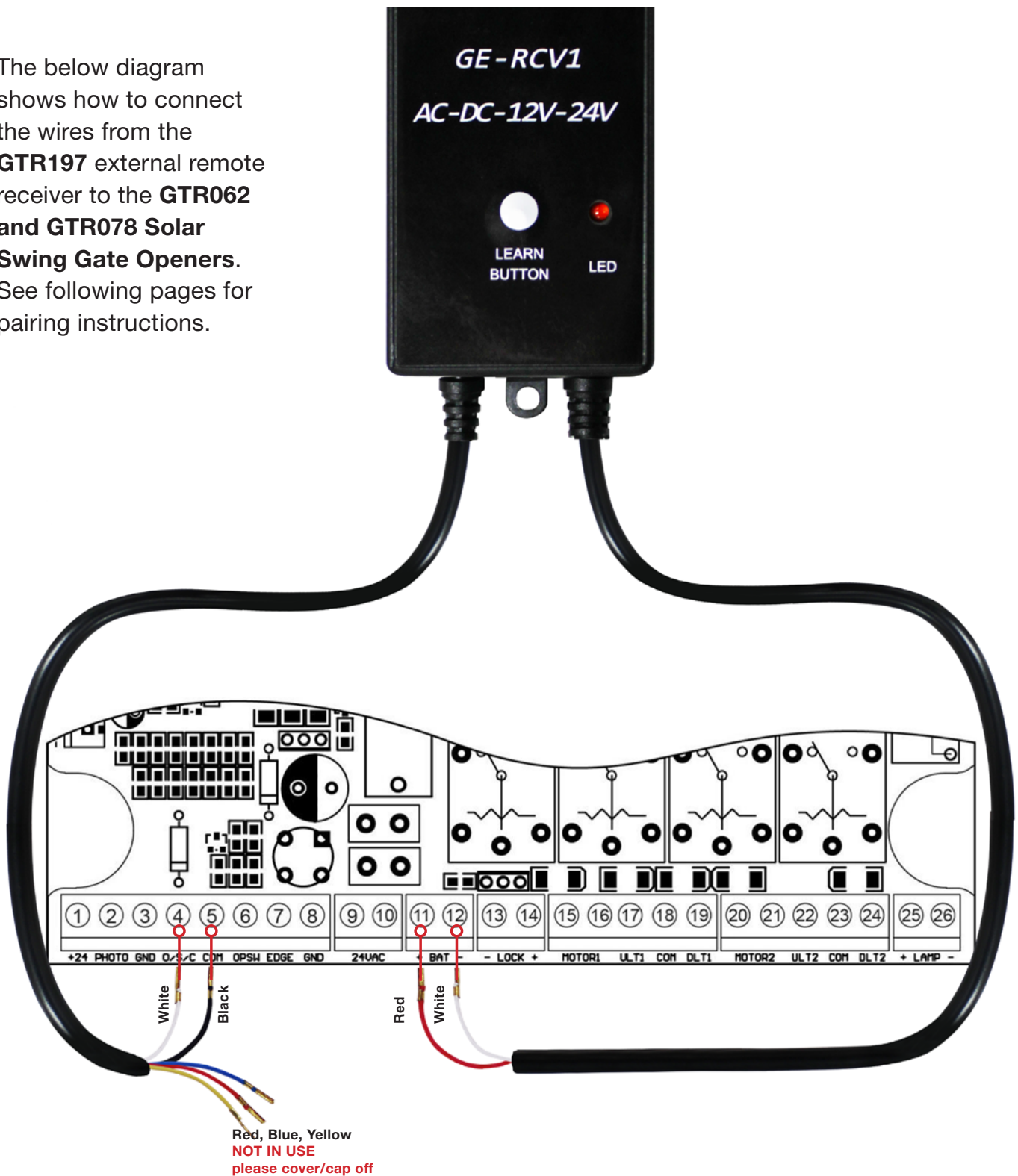

# Connecting the GTR197 to a non-Richmond Opener

Below is an example of how the GTR197 external receiver will wire into a non-Richmond opener to allow you to use your existing Richmond remote.

1. To power the external receiver, you will need a 12 or 24 volt AC or DC power supply.  
In the example below, this is marked as “External Accessory Power”

2. To operate the gate/garage opener, the external receiver will need to connect into the PC board.

**For residential openers**, most will have an input for an external push button. In the example below, terminals 2 & 5 are used for the push button. This will be the input for your external receiver.

**For commercial openers**, some may have separate functions for Open, Stop and Close.  
The wiring example below will support this function

**For the below example, the GTR197 external receiver would be wired as follows:**

GTR197 Red + into External Accessory Power Terminal +

GTR197 White GRN into External Accessory Power Terminal -

GTR197 Black COM into Terminal Block Terminal 2

GTR197 White OPEN into Terminal Block Terminal 1

**If you need assistance finding your connection points, or are unsure if your motor is suitable, please contact the team at Richmond Wheel & Castor Co.**

## Control Panel:

- External Accessory Power:** 30V dc 50 mA available for universal receiver
- Terminal Block:** Used for external accessories (see chart below)

Residential Opener		
No	Function	Description
0	Ground	24volt DC Negative
1	24vDC+	24volt DC Positive
2	O/S/C	Dry Contact Input for Push Button
3		
4		
5	COM	Common Terminal
6	Lamp +	24vDC + for Warning Lamp
7	Lamp -	24vDC- for Warning Lamp

Commercial Opener		
No	Function	Description
0	Ground	24volt DC Negative
1	24vDC+	24volt DC Positive
2	Open	Dry Contact Input for Manual Console
3	Stop	Dry Contact Input for Manual Console
4	Close	Dry Contact Input for Manual Console
5	COM	Common Terminal
6		24vDC + for Warning Lamp
7		24vDC- for Warning Lamp

Wiring Example	
GTR197 Wire	Input
Red+	Terminal 1 = 24vDC +
White GRN	Terminal 0 = 24vDC -
White Channel 1	Terminal 2 = O/S/C
Black COM	Terminal 5 = Common

Wiring Example	
GTR197 Wire	Input
Red+	Terminal 1 = 24vDC +
White GRN	Terminal 0 = 24v DC -
White Channel 1	Terminal 2 = Open
Yellow Channel 2	Terminal 3 = Stop
Red Channel 3	Terminal 4 = Close
Black COM	Terminal 5 = Common

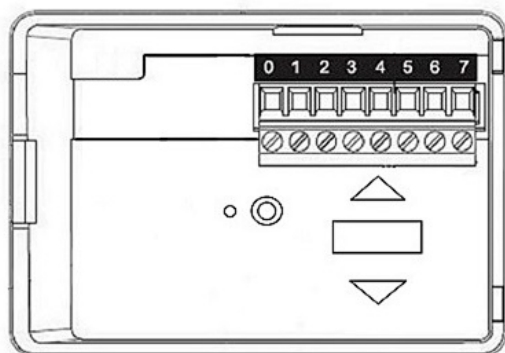

# Pairing Remotes to the Remote External Receiver

**PLEASE NOTE:** these instructions use the GTR179 remote which comes standard with the following Richmond gate openers: GTR064, GTR061, GTR156, and GTR207

## Step 01.

Press the learn button on the external receiver once. The LED on the receiver will turn on.

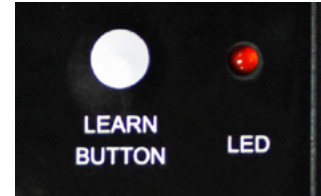

## Step 02.

Press the first button (1) on the remote twice.

The learn LED will flash and then turn off.

The remote is now paired

This process can be repeated using buttons 2 and 3 to pair to multiple motors or receivers.

**Example: Button 1 - Gate Motor | Button 2 - Garage Motor**



## GTR197 Technical Specs

- Quantity of control channels: 1st 2nd 3rd 4th
- Operating supply voltage: 9V-35V DC / 8V-26V AC
- Current consumption (not more than): 30mA – standby mode / 70mA – output activation
- Operating frequency: 433.92MHz
- Quantity of receivable remotes: up to 250pcs
- Relay output: NO (normally-open)
- Load of relay output contact: 1A max., 24V DC / 0,5A max., 125V AC
- Case protection rating: IP40
- Environment temperature: -20° ... +50°
- Overall dimensions (not more than): 78mm x 44mm x 25mm
- Length of connection cables (not less than): 450mm
- Weight: 80g